



Instruction Manual

Count On Me Self-Checkout™



INTRODUCTION

Thank you for purchasing the **Count On Me Self-Checkout™** by **VTech®**! Shop for essentials like eggs, bread and milk. Play games, fill your basket and head to the checkout counter to scan items and check the prices. Pay with cash or card and bag up your groceries. Thanks for shopping!



1	Silly Sandwich Mode Button	12	Shopping Light
2	Shopping List Mode Button	13	Volume Button
3	Sale Mode Button	14	Announcement Button
4	Shopping Mode Button	15	Plus Button
5	Category Buttons	16	Credit Card Button
6	Number Buttons	17	Minus Button
7	Backspace Button	18	Equal Button
8	Card Payment Button	19	Check Out Button
9	Scanner	20	Cash Payment Button
10	Singing Fun Button	21	Coin Slot
11	On/Off Button	22	Change Drawer

INCLUDED IN THE PACKAGE

- Self-Checkout Kiosk
- Base



- Change Drawer



- 2 Stabilization Feet



- Bagging Area



- Can of Tomatoes



- Apple

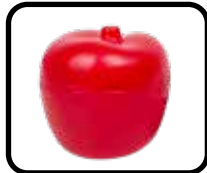

- Broccoli



- Steak



- Bread



- Eggs



- 6 Food Boxes



- 45 Banknotes



- 10 Coins



- Credit Card



- Shopping Basket



- Paper Bag



- 2 Insert Cards



- 3 Label Sheets



- 8 Screws



- Quick Start Guide



WARNING

All packing materials such as tape, plastic sheets, packaging locks, removable tags, cable ties, cords and packaging screws are not part of this toy, and should be discarded for your child's safety.

NOTE

Please save this Instruction Manual as it contains important information.

ATTENTION

Pour la sécurité de votre enfant, débarrassez-vous de tous les produits d'emballage tels que rubans adhésifs, feuilles de plastique, attaches, étiquettes, cordons et vis d'emballage. Ils ne font pas partie du jouet.

NOTE

Il est conseillé de sauvegarder ce manuel d'utilisation car il comporte des informations importantes.

Unlock the Packaging Locks

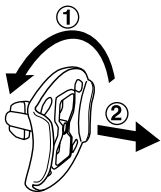

- ① Rotate the packaging locks 90 degrees counterclockwise.
- ② Pull out the packaging locks.

LABEL APPLICATION

Please securely place the stickers on the playset as indicated below:

1. On the Can of Tomatoes
2. On the Change Drawer

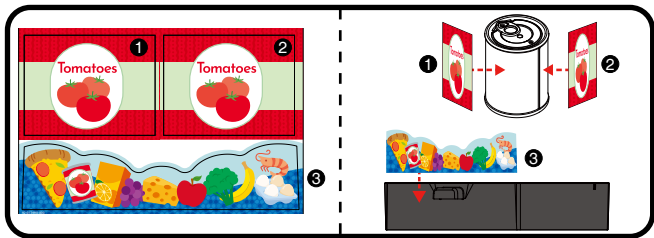

ASSEMBLY

With the **Count on Me Self-Checkout™** safety comes first. To ensure your child's safety, adult assembly is required.

1. Align the **Self-Checkout Base** to the top of the unit, then use a screwdriver to tighten eight screws.
2. Snap the **Stabilization Feet** into the left and right slots on the back of the **Self-Checkout Base**.

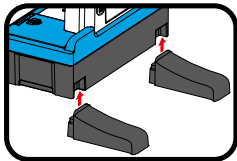
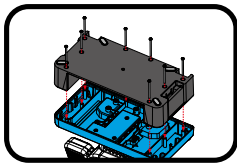

3. Snap the **Bagging Area** into the slot on the left of the **Self-Checkout Base**.

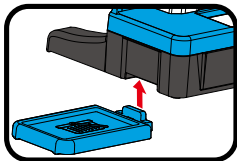

4. Fold the **Six Food Boxes** to play. Fold the **Pizza Box** as shown below.

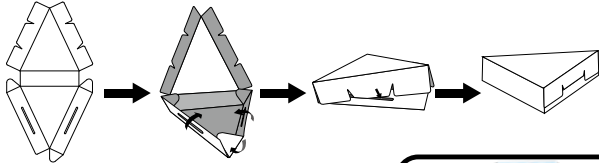

5. Insert **Paper Cards** into the **Self-Checkout Unit** as shown.



GETTING STARTED

Exit Try-Me Mode:

The product is in Try-Me mode in the packaging. To exit Try-Me mode, turn **On** the unit, then insert a **coin** into the **coin slot**. You will hear a beep and the screen will display “Normal mode” then enter Sleep mode. Press the **On/Off Button** to enter normal play.



⚠ WARNING:

Adult assembly required for battery installation.
Keep batteries out of reach of children.

⚠ ATTENTION :

Les piles ou accumulateurs doivent être installés par un adulte.
Tenir les piles ou accumulateurs hors de portée des enfants.

Battery Removal and Installation

1. Make sure the unit is turned **Off**.
2. Find the battery cover located on the bottom of the unit and use a screwdriver to loosen the screw, then open the battery cover.
3. Remove old batteries by pulling up on one end of each battery.
4. Install 3 new 1.5V AA (LR6) batteries following the diagram inside the battery box. (For best performance, alkaline batteries or fully charged Ni-MH rechargeable batteries are recommended.)
5. Replace the battery cover and tighten the screw to secure.

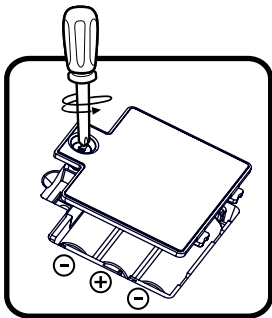

IMPORTANT: BATTERY INFORMATION

- Insert batteries with the correct polarity (+ and -).
- Do not mix old and new batteries.
- Do not mix alkaline, standard (carbon-zinc) or rechargeable batteries.
- Only batteries of the same or equivalent type as recommended are to be used.
- Do not short-circuit the supply terminals.
- Remove batteries during long periods of non-use.
- Remove exhausted batteries from the toy.
- Dispose of batteries safely. Do not dispose of batteries in fire.

RECHARGEABLE BATTERIES:

- Rechargeable batteries are only to be charged under adult supervision.
- Do not charge non-rechargeable batteries.

IMPORTANT : INFORMATIONS CONCERNANT LES PILES

- Mettre en place les piles ou les accumulateurs en respectant les polarités + et –.
- Ne pas mélanger des piles ou des accumulateurs neufs avec des usagés.
- Ne pas mélanger différents types de piles : alcalines, zinc-carbone et rechargeables.
- Seules des piles du type recommandé doivent être utilisées.
- Ne pas mettre les bornes d'une pile ou d'un accumulateur en court-circuit (en reliant directement le + et le –).
- Retirer les piles ou les accumulateurs en cas de non-utilisation prolongée.
- Enlever les piles ou les accumulateurs usagés du jouet.
- Ne les jeter ni au feu ni dans la nature.

PILES RECHARGEABLES

- Les accumulateurs ne doivent être chargés que sous la surveillance d'un adulte.
- Ne pas tenter de recharger des piles non rechargeables.

PRODUCT FEATURES

1. ON/OFF BUTTON

Press the **On/Off Button** to play.



2. VOLUME BUTTON

Press to adjust the volume.



3. SHOPPING MODE BUTTON

Push for pretend shopping. Press **Grocery Buttons** to hear fun facts; scan objects, checkout and pay.



4. SALE MODE BUTTON

Press to play sale games. Match numbers, practice simple addition or count and scan items!



5. SHOPPING LIST MODE BUTTON

Match items to your list as they pass the register!



6. SILLY SANDWICH BUTTON 🍌

Press to build a sandwich. Push 3 **Grocery Buttons** to make your sandwich. What will you make?



7. SINGING FUN 🎵

Press to hear fun songs about numbers and groceries.



8. CATEGORY BUTTONS 🍏🍌

Press to hear fun facts about each item or answer questions in games.



9. ANNOUNCEMENT BUTTON 🌟

Press to hear shopping announcements.



10. NUMBER BUTTONS

Press the 0-9 **Number Buttons**.



11. BACKSPACE BUTTON

Use the **Backspace Button** to delete a number.



12. PLUS / MINUS / EQUAL BUTTONS

Press the **Plus / Minus Buttons** to add or subtract. Check your total by pressing the **Equal Button**.



13. CHECK OUT BUTTON

Press to show your total and get ready to checkout.



14. CARD PAYMENT BUTTON

Press to choose payment by credit card.



15. CASH PAYMENT BUTTON

Press to choose payment by cash.



16. CREDIT CARD BUTTON



When you choose pay by card, press the **Credit Card Panel** to finish the payment.



17. SCANNER

Slide objects across the **Scanner** to see prices. Avoid playing under direct sunlight as this may limit performance.



18. COIN SLOT

Insert **Coins** into the **Coin Slot** to play games, count, or pay for groceries.



19. AUTOMATIC SHUT-OFF

To preserve battery life, the **Count on Me Self-Checkout™** will automatically power down after several seconds without input. The **Count on Me Self-Checkout™** can be turned on again by pressing the **On/Off Button**. The unit will automatically turn off when battery power is low. If you see the Low Battery icon appear on screen, replace the batteries.

ACTIVITIES

1. SHOPPING MODE

1.1 Scanning

Swipe objects across the **Scanner** to display a price, then press the **Checkout Button** to complete your purchase! The maximum total amount is \$100.



- **Payment process:**

Press a **Payment Button** to choose cash or credit to pay your bill.



- **Credit card payment:**

Press the **Credit Card Panel** to finish the payment.



- **Cash payment:**

Use **Play Money** or **Coins** to pay with cash. Then, press the **Checkout Button** to finish your payment.



1.2 Calculator

Do simple calculation with the **Calculator**. Use the **Backspace Button** to clear a number.



1.3 Category Buttons

Press **Category Buttons** to hear fun facts about the items. Check the price by pressing the **Checkout Button**.

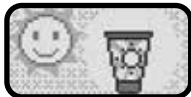

2. SALE MODE

2.1 Scan the number of items shown on the screen, then press the **Checkout Button**. Insert the number of **Coins** shown to complete your purchase.



2.2 Identify the total number of items on the screen and press the correct **Number Button** to answer basic math questions.



3. SHOPPING LIST MODE

In this matching game, Groceries roll by on the conveyor belt. Press the **Checkout Button** when an item on your list reaches the checkout area on the left.



4. SILLY SANDWICH MODE

Let's make a silly sandwich! Press three **Category Buttons** to choose items for your sandwich. Let's see what you make!



5. SINGING FUN

Press **Category, Checkout, Payment** and **Number Buttons** to hear different songs. Use **Plus, Minus** and **Equal** buttons to hear sound effects.

SONG LYRICS

SONG 1

Let's look at our shopping list
And see what we can find.
We're looking for some [Item]
Oh, it's right down aisle [Number]

SONG 2

We have a list of things to buy.
Let's make shopping fun today!
When you find the [Item], shout hooray!
Put it in your bag then wave goodbye.

SONG 3

Raise your hands and jump around
Look at all the things we found.
Sing and clap and stomp your feet
Yummy food so very sweet

SONG 4

One, two, three,
Shop and sing with me.
Four, five, six
What foods did you pick?
Seven, eight, nine and ten
Check that price again.

CARE & MAINTENANCE

1. Keep the unit clean by wiping it with a slightly damp cloth.
2. Keep the unit out of direct sunlight and away from any direct heat sources.
3. Remove the batteries if the unit will not be in use for an extended period of time.
4. Do not drop the unit on hard surfaces and do not expose the unit to excess moisture.

TROUBLESHOOTING

If for some reason the program/activity stops working or malfunctions, please follow these steps:

1. Please turn the unit **Off**.
2. Interrupt the power supply by removing the batteries.
3. Let the unit stand for a few minutes, then replace the batteries.
4. Turn the unit **On**. The unit should now be ready to use again.
5. If the unit still does not work, install a new set of batteries.

IMPORTANT NOTE

If the problem persists, please call our **Consumer Services Department** at **1-800-521-2010** in the U.S., **1-877-352-8697** in Canada, or visit our website **vtechkids.com** and fill out our **Contact Us** form located under the **Customer Support** link. Creating and developing **VTech®** products is accompanied by a responsibility that we take very seriously. We make every effort to ensure the accuracy of the information, which forms the value of our products. However, errors sometimes can occur. It is important for you to know that we stand behind our products and encourage you to contact us with any problems and/or suggestions you might have. A service representative will be happy to help you.

NOTE

This equipment has been tested and found to comply with the limits for a Class B digital device, pursuant to Part 15 of the FCC Rules. These limits are designed to provide reasonable protection against harmful interference in a residential installation. This equipment generates, uses and can radiate radio frequency energy and, if not installed and used in accordance with the instructions, may cause harmful interference to radio communications. However, there is no guarantee that interference will not occur in a particular installation. If this equipment does cause harmful interference to radio or television reception, which can be determined by turning the equipment off and on, the user is encouraged to try to correct the interference by one or more of the following measures:

- Reorient or relocate the receiving antenna.
- Increase the separation between the equipment and receiver.
- Connect the equipment into an outlet on a circuit different from that to which the receiver is connected.
- Consult the dealer or an experienced radio/TV technician for help.

CAUTION

Changes or modifications not expressly approved by the party responsible for compliance could void the user's authority to operate the equipment.

Supplier's Declaration of Conformity

47 CFR § 2.1077 Compliance Information

Trade Name: VTech®
Model: 5915
Product Name: Count On Me Self-Checkout™
Responsible Party: VTech Electronics North America, L.L.C.
Address: 1156 W. Shure Drive, Suite 200
Arlington Heights, IL 60004
Website: vtechkids.com

THIS DEVICE COMPLIES WITH PART 15 OF THE FCC RULES. OPERATION IS SUBJECT TO THE FOLLOWING TWO CONDITIONS: (1) THIS DEVICE MAY NOT CAUSE HARMFUL INTERFERENCE, AND (2) THIS DEVICE MUST ACCEPT ANY INTERFERENCE RECEIVED, INCLUDING INTERFERENCE THAT MAY CAUSE UNDESIRE OPERATION.
CAN ICES(B)/NMB(B)

**Visit our website for more
information about our products,
downloads, resources and more.**

vtechkids.com
vtechkids.ca

Read our complete warranty policy online at
vtechkids.com/warranty
vtechkids.ca/warranty

